

# Data Log Form

Customer Name/Phone: PAUL SMITH 555-555-5555

Date of Measurements: 8/5/10

Services Requested: NOISE SOURCE CHARACTERIZATION & LOCATION

Description of Issue: THERE IS AN OFFENDING NOISE COMING FROM SOMEWHERE IN OUR LAB. I WANT TO KNOW WHERE, AND MORE ABOUT ITS CHARACTERISTICS.

Index	Time	Location Description (include direction of measurement)	SPL	Rec Number(s) (DR000xx.wav)	Comments
A	11:15	POINT "A" ON MY MAP FACING EAST	50.3	10-12	
B	11:20	POINT "A" FACING SOUTH	50.7	13-15	
C	11:25	POINT "A" FACING <del>WEST</del> UP	48.5	16-18	Whoops! PUT UP INSTEAD OF WEST. DISREGARD
D	11:30	POINT "A" FACING <del>WEST</del> WEST	49.2	19-21	
E	11:30	POINT "A" FACING NORTH	50.5	22-24	
F	11:35	POINT "B" FACING NORTH	47.2	25-27	
G	11:40	POINT "B" FACING EAST	46.3	28-30	
H	11:45	POINT "B" FACING SOUTH	46.5	31-33	
I	11:50	POINT "B" FACING WEST	46.0	34-36	
J					
K					
L					
M					
N					
O					
P					
Q					

See second page for space to provide drawings of measurement locations as well as additional notes.

BECAUSE AN INHERENT DANGER EXISTS WITH HIGH SOUND LEVEL and may require hearing protective devices, such conditions exist that may jeopardize the safety of yourself or others or if you are unsure about proper equipment use, DO NOT USE THE EQUIPMENT and call QRDC at 952-556-5205. FAILURE TO COMPLY WITH ALL SAFETY INSTRUCTIONS OR THOSE OF OSHA AND YOUR FEDERAL, STATE OR LOCAL GOVERNMENTS, MAY RESULT IN HEARING LOSS. QRDC accepts no liability for failure to comply.

**Location Descriptions** – Use the area below to depict the environment in which sound recordings are being made. Be as detailed as you are willing, but be sure to include objects such as: walls, operating equipment, large obstructions (like bookcases, furniture, etc), and any other potential sources of noise (for example, computers, air vents, etc). Also, try to be as true to scale as possible, and feel free to label distances and dimensions. We also identify North as the “up” direction. It is not important whether your drawing reflects North correctly, but it serves as a way of identifying relative direction (for example, you can record on the log sheet that the direction of the measurement device was NW, and this will all be relative to the drawing below).

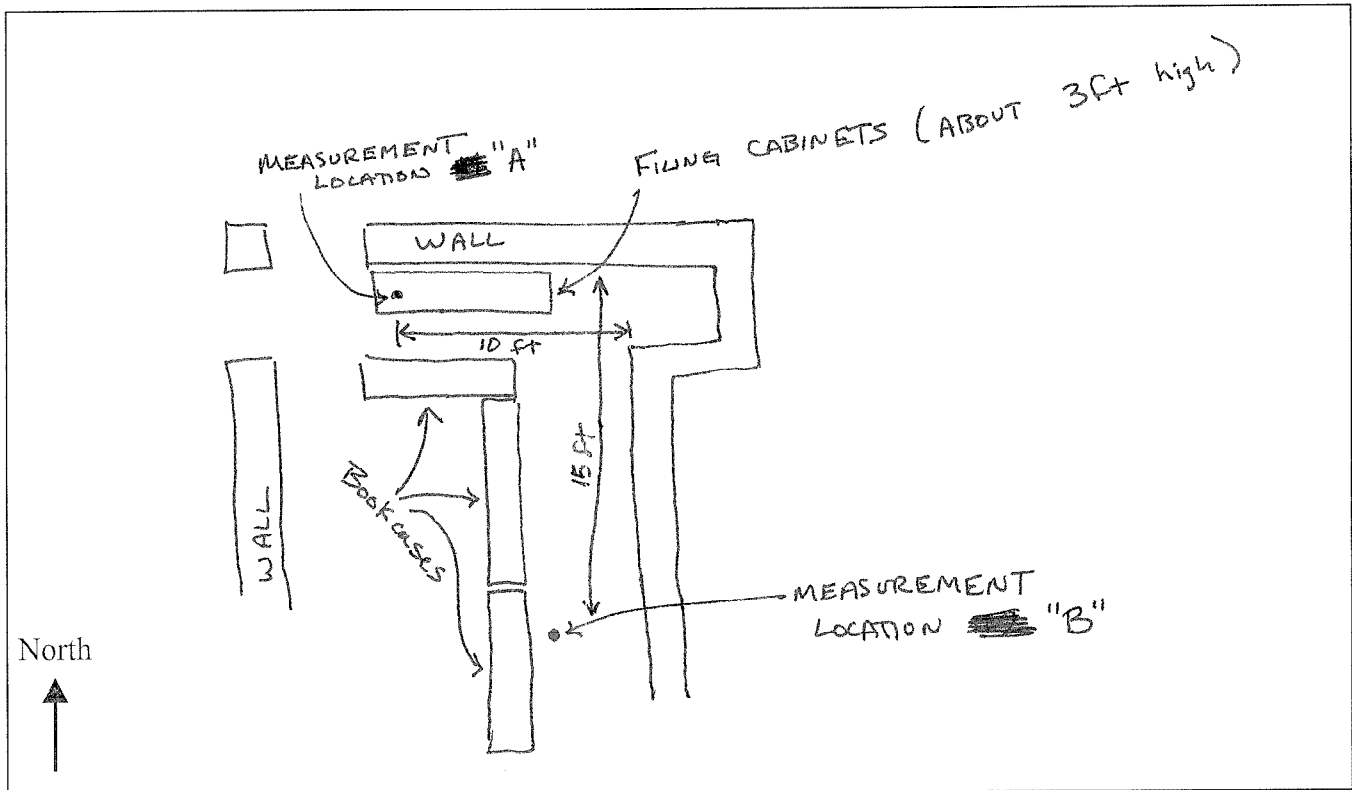

**Additional Comments/Notes:**

- MEASUREMENT LOCATION #1 IS ON TOP OF THE FILING CABINET.
- MEASUREMENT LOCATION #2 IS ABOUT 2-3 ft high, HELD BY HAND.